

Stillwater County
On-site Wastewater Treatment System Permit

Permit to Install, an on-site wastewater treatment system. The on-site wastewater treatment system shall be inspected and approved by the local sanitarian before covering. The on-site wastewater treatment system shall be installed in accordance with State and Local Board of Health Regulations.

This permit is issued to:

Gerhardt, Nancy & Randy

Property Owner

3446 Winchell Lane

Billings, MT 59102

Mailing Address

To install an On-site Waste Water Pressure-Dosed Distribution System for a (4) bedroom single family dwelling in accordance with plans approved by Stillwater County.

At: 112 Piskun Rd., Nye MT 59061

Buffalo Jump Ranch Lot 7 COS 209850 (10.00 acres)

COPY

05S	16 E	06
Township	Range	Section

The on-site wastewater treatment system shall be installed accordingly to the follow conditions:

- 1) **Must be inspected by a Local Sanitarian before backfilling.**
- 2) **Approved for a pressure dosed distribution drainfield.**
- 3) **Septic system is based on 350 gallons per day flow.**
- 4) **The septic system shall consist of 1500 gallon septic tank and 500 gallon dose tank.**
- 5) **The dosing tank is to be equipped with audio and visual high water alarm.**
- 6) **The septic tank shall have an effluent filter installed on the discharge outlet.**
- 7) **Drainfield shall consist of 3 (58) foot runs of 34 inch wide pressure-dosed gravelless chambers, a total of 175 linear feet. Cleanouts must be provided at the end of every lateral.**
- 8) **Lateral trenches are 7-10 feet apart.**
- 9) **Bottom of the drainfield trenches shall be at least four feet above bedrock.**

This permit is being issued under the conditions set forth in the permit application and/or subsequent conditions herewith attached. The approval of this permit has been based on the information submitted and is not valid if that material contains any substantive errors, inaccuracies, or misrepresentations, or if any substantive changes from the proposed application are made.

This permit issued on this October 22, 2013

System is to be installed by

Stephanie Moody R.S.
Sanitarian

Mountain Excavating
A Stillwater County Licensed Installer

***Permit valid for 2 years from date of permit.**

ON SITE SEWAGE DISPOSAL
PERMIT APPLICATION

RECEIVED
10/21/13



STILLWATER COUNTY
ENVIRONMENTAL HEALTH DEPARTMENT
PO BOX 1276, 809 E. 4TH AVE. NORTH SUITE B
COLUMBUS, MT. 59019
322-8055 Fax: 322-1118

APPLICATION NO. _____

OFFICE USE ONLY

FEE PAID

150.00

CHECK #

3366

Owner of Record Nancy + Randy Gerhardt Date: 10/17/13
Phone: (406) 698-5506
Address of Record Owner 3446 Winckell Lane, Billings, MT 59102
Rural Address 112 Bishop Rd, Nye, MT 59069
Legal Description Buffalo Jump Ranch, Sub, TOS S, R16R Lot 7, COS 209850
Name Of Subdivision & Parcel Identification: Buffalo Jump Subdivision, 32052800301040000
Size of Parcel: 10 Acres
Number of Bedrooms: 4 Type of Dwelling Residence

SITE EVALUATION

Percolation Rate _____ min/in -- Soils Application Rate _____ gpd/ft.
Depth to Seasonal High Groundwater 8 plus feet
How was this determined? test hole
Date Determined 10/16/13
Depth to Bedrock over 8'

DISPOSAL SYSTEM

Septic tank size 1,500 gal Length Drainfield 219 ft.
Distance from septic tank to foundation 10' ft.
Distance from septic tank to property line 180' ft.
Distance from septic tank to well N/A - Cistern 75' ft.
Distance from septic tank to state water (irrigation, stream, lake or pond) 3/4 mile ft.
Distance from septic tank to 100 year floodplain 300' (pond) ft.
Distance from drainfield to foundation 200' ft.
Distance from drainfield to property line 120' ft.
Distance from drainfield to well N/A - Cistern ft.
Distance from drainfield to state water (irrigation, stream, lake or pond) 3/4 mile ft.
Distance from drainfield to 100 year floodplain 100' ft.
Distance from drainfield to any slope of 25% or greater 40' ft.

Please include a sketch of proposed disposal system (include unit, nearest well, stream, irrigation ditch, lake, 100 year floodplain).

I hereby acknowledge that the sewage disposal system for the above dwelling or facility will be installed by a Stillwater County approved licensed installer or self installed.

Owner of Record Nancy Gerhardt ²⁶
Signature

Installer Vince @ Mantain Excavating
Name

STILLWATER COUNTY

Septic System Site Evaluation

Property Owner: Gerhardt, Nancy & Randy

Date: 10/16/2013

Mailing Address: 3446 Winchell Lane, Billings MT 59102

Rural Address: 112 Piskun Rd., Nye, MT 59061

Legal Description: T: 5S R: 16E Section: 6

1/4 Sec: _____

Subdivision: Buffalo Jump Ranch Lot #: Lot 7

Lot Size: 10.006

GPS: lat.long _____ Latitude: _____ Longitude: _____

Evaluation Performed By: Stephane Moore

Water Supply

Proposed Well: _____

Multi-family: _____

Proposed Cistern: Yes

Public Water: _____

PWID: _____

Spring: _____

Existing Well: _____

Depth: _____

Existing Cistern: _____

Size: _____

Soils:

Soils Test Pit Analysis

Depth:	Soils Classification:	Structure:	Color:
<u>0</u> to <u>2</u>	<u>Sandy Clay loam</u>	<u>Granular</u>	<u></u>
<u>2.5</u> to <u>3</u>	<u>Sandy Clay loam</u>	<u>"</u>	<u></u>
<u>3</u> to <u>7</u>	<u>Loam - Sandy loam</u>	<u>Smears</u>	<u></u>
_____ to _____	_____	<u>"</u>	<u></u>

NRCS Soil Survey Classification: _____

Signs of Water: no

If Yes what Depth: _____

Signs of Mottling: no

If Yes what Depth: _____

Ground Water Monitoring Required: no

Note: Monitoring required if seasonal high table is suspected to be less than 7 feet.

Signs of Bedrock: no

If Yes what Depth: _____

Site Evaluation Data:

Slope across proposed drainfield: 43 %

Distance of proposed drainfield to nearest surface water: 100 ft

Type/Name of nearest surface water: Seasonal Pond from stormwater

Distance of proposed drainfield to well: NA ft Cistern: 100+ ft

Distance of proposed drainfield to floodplain: 1000+ ft 25% Slope: 43 ft

Comments/Notes:

STILLWATER COUNTY

Septic System Installation Inspection

Property Owner: Gerhardt Nancy & Randy Date: 10/24/2013
Mailing Address: 3446 Winchell Lane Permit #: 13-51
Rural Address: 112 Piskun Rd. Nye MT
Legal Description: T: 5S R: 16E Section: 6 1/4 Sec: _____
Subdivision: Buffalo Sump Ranch Lot #: _____ Lot Size: _____
GPS. Lat-Long Latitude: _____ N Longitude: _____ S

Type of System

Standard System

With Gravel ☐
Gravelless ☐

Gravity Dosed

With Gravel ☐
Gravelless ☐

Pressure Dosed

With Gravel ☐
Gravelless ☒
Sand Mound ☐
-Sand Filter ☐

Other _____

Absorption Trenches

Laterals 3 #
Pipe Diameter _____ in
Width 34 in
Max. Depth 36 in
Length 60 ft
Seperation 7.5 ft

Sand Mound/Filter

Area _____ sqft
Volume _____ cuft
Discription _____

Septic Tank: Volume

Concrete 1500 g
Poly _____ g

Dosing Tank:

Concrete 1000 g
Poly _____ g

Combination Tank:

Concrete Septic _____ g
Dosing _____ g
Poly Septic _____ g
Dosing _____ g

Drainfield to: Well NA ft
Cistern NA 100+ ft
Septic Tank 133 ft
25% Slope 25+ ft
Surface Water 118 ft
Property Line 100+ ft

Septic Tank to: Well NA ft
Foundation 12 ft
Property Line 100+ ft

Distribution Box _____

D-Box Flow Control _____

Meets Non-Deg _____

Approved By: Stephanie Moody RS

Installed By: Mountain Excavation
Vince Baker

Comments: _____

~~WAM~~ Pishkun Rd.

2 (2200) gallon
cisterns



Driveway

91 ft

Driveway

1500 gallon
septic tank
& filter

12 ft

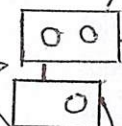

1000 gallon
dose tank

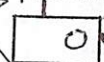

cleanout

Alarm system
to be installed
by electrician

Garage doors

House

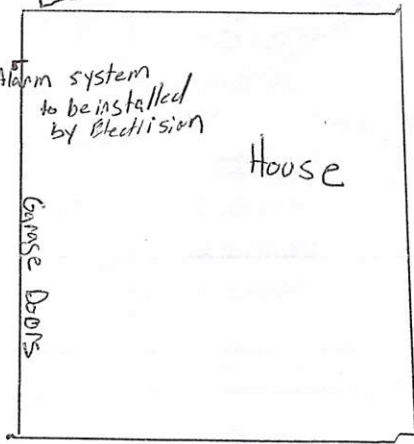

133 ft

Hillside

60 ft

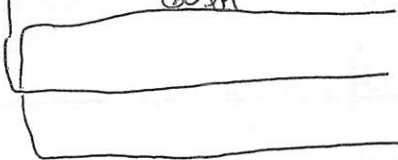

pressure dose
drain field
& valves

118 ft

pooling
water
from run off

